

SMD soldering tip for device series MX for component SOIC-16, series 700/412 °C

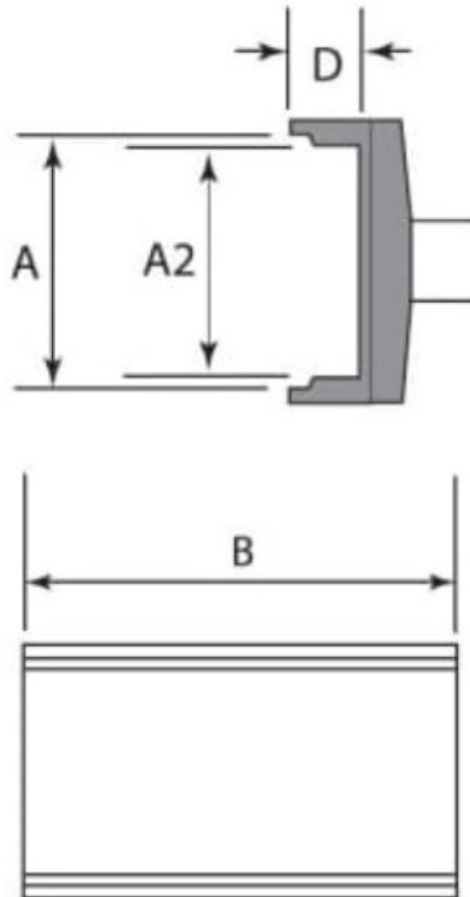

- A = 8.13mm
- A2 = 8.13mm
- B = 11.94mm
- D = 6.86mm

| | |
|--------------------------|--|
| Item no. | WL24672 |
| Model | SMTC-1124 |
| Manufacturer | METCAL |
| Manufacturer article no. | SMTC-1124 |
| GPSR manufacturer data | OK International Ltd Eagle Close, Chandlers Ford GB-SO53 4NF Hampshire |

www.metcal.com

| | |
|----------------------------------|--------------------|
| Sales unit | 1 piece |
| Content unit | 1 piece |
| Incl. battery | no |
| Product series | SMTC Series |
| Soldering tip temperature (max.) | 412 °C |
| Tip series | SMTC |
| Tip shape | special form |
| Tip alignment | straight |
| Matching handpiece | MX-H1-AVA, MX-RM3E |
| ESD compliant | no |

