

## SMT adapter for SMD tips to WSP80

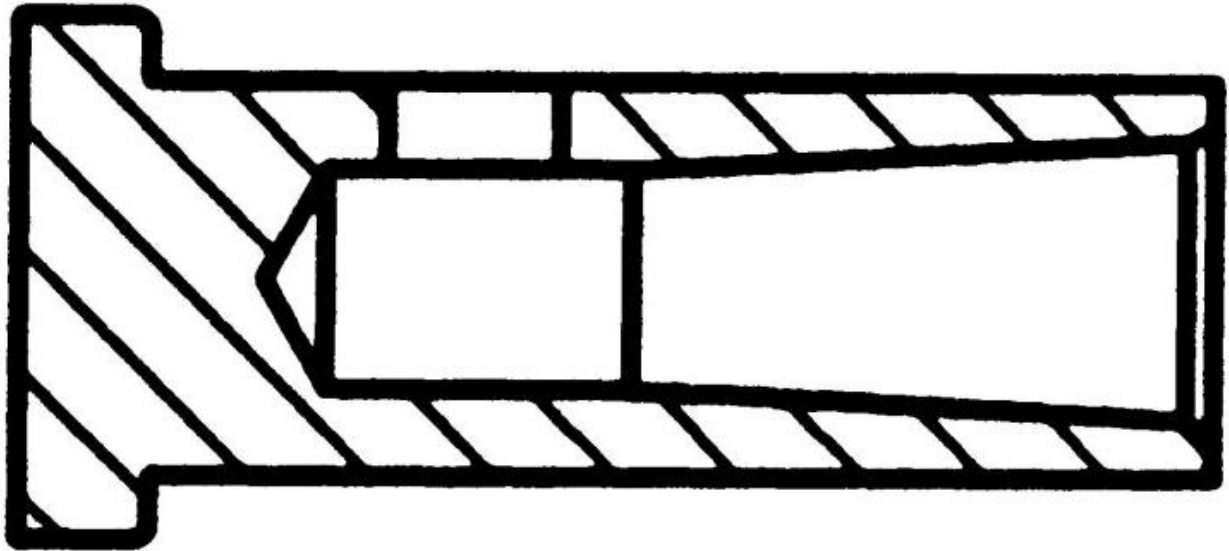

The SMT adapter for SMD tips from Weller is specially designed for use with the WSP80 soldering iron. This adapter enables seamless integration of SMD tips, facilitating precise soldering work on sensitive electronic components. The high-quality workmanship guarantees reliable performance and durability. Easy handling and quick tip changes make the work process more efficient. The SMT adapter is an ideal addition to the WSP80 for mastering demanding soldering tasks with high precision.

Item no.	WL16527
Model	SMT
Manufacturer	WELLER
Manufacturer article no.	T0054441799
GPSR manufacturer data	WELLER Tools GmbH Carl-Benz-Strasse 2 DE-74354 Besigheim www.weller.eu
Sales unit	1 piece
Content unit	1 piece